

FAN COIL

Flexible Connectors

These product are designed according to customer requests.

Hose shape is similar to solar hose.

This product group is ready-to-install products.

They create cost advantages for manufacturers due to easy assembly.

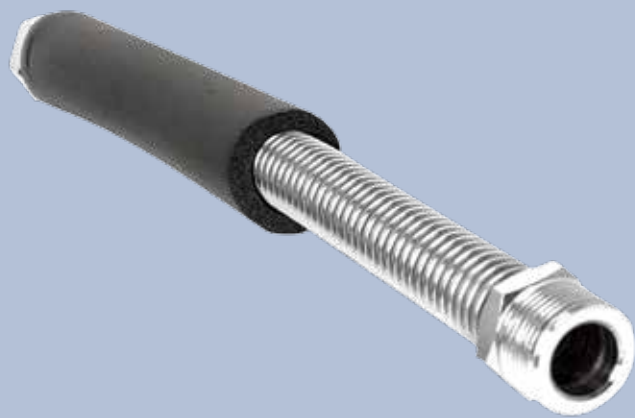

Advantages

- » Fan-coil connectors are used for flexible connections of fan-coil units to the heating / cooling system distribution piping
- » They are easy to assemble

Applications

- » Fan-coil units
- » Heating / cooling system

DESIGN VALUES

Without Braid	MH 201 OG, MH 211 OG
With Braid	MH 201 MG
Hose Material	304, 316L
Braid Material	304
Working Pressure	0-21 barg
Sizes	DN12-DN50

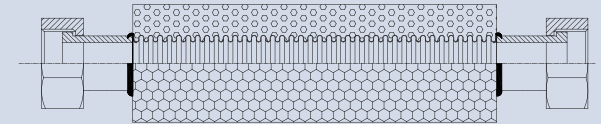

201 OG

DN		Type	d1	d2	Tolerance	Fitting 1	Fitting 2	Insulation Thickness	Length
mm	inch		mm	mm		mm	mm		
DN12	1/2"	201 OG	12,1	16,7	±0,2	1/2" Male	1/2" Male	13	200-300-400-500-600-700-800-900-1000
DN12	1/2"	201 OG	12,1	16,7	±0,2	1/2" Male	1/2" Female	13	200-300-400-500-600-700-800-900-1000
DN16	5/8"	201 OG	16,2	21,6	±0,2	3/4" Male	3/4" Male	13	200-300-400-500-600-700-800-900-1000
DN16	5/8"	201 OG	16,2	21,6	±0,2	3/4" Male	3/4" Female	13	200-300-400-500-600-700-800-900-1000
DN20	3/4"	201 OG	20,3	26,8	±0,2	1" Male	1" Male	13	200-300-400-500-600-700-800-900-1000
DN20	3/4"	201 OG	20,3	26,8	±0,2	1" Male	1" Female	13	200-300-400-500-600-700-800-900-1000
DN25	1"	201 OG	25,3	32,3	±0,3	1 1/4" Male	1 1/4" Male	13	200-300-400-500-600-700-800-900-1000
DN25	1"	201 OG	25,3	32,3	±0,3	1 1/4" Male	1 1/4" Female	13	200-300-400-500-600-700-800-900-1000

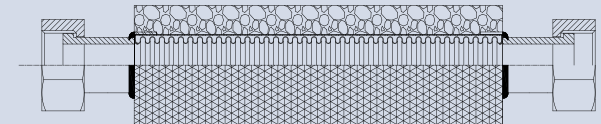

201 MG

DN		Type	d1	d2	Tolerance	Fitting 1	Fitting 2	Insulation Thickness	Length
mm	inch		mm	mm		mm	mm		
DN12	1/2"	201 MG	12,1	18,1	±0,2	1/2" Male	1/2" Male	13	200-300-400-500-600-700-800-900-1000
DN12	1/2"	201 MG	12,1	16,7	±0,2	1/2" Male	1/2" Female	13	200-300-400-500-600-700-800-900-1000
DN16	5/8"	201 MG	16,2	23,2	±0,2	3/4" Male	3/4" Male	13	200-300-400-500-600-700-800-900-1000
DN16	5/8"	201 MG	16,2	23,2	±0,2	3/4" Male	3/4" Female	13	200-300-400-500-600-700-800-900-1000
DN20	3/4"	201 MG	20,3	28,4	±0,2	1" Male	1" Male	13	200-300-400-500-600-700-800-900-1000
DN20	3/4"	201 MG	20,3	28,4	±0,2	1" Male	1" Female	13	200-300-400-500-600-700-800-900-1000
DN25	1"	201 MG	25,3	34,4	±0,3	1 1/4" Male	1 1/4" Male	13	200-300-400-500-600-700-800-900-1000
DN25	1"	201 MG	25,3	34,4	±0,3	1 1/4" Male	1 1/4" Female	13	200-300-400-500-600-700-800-900-1000